

- 1** .5 SPHERE MOUNT
.5 SM
- .5 SPHERE MOUNT NEGATIVE
.5 SMN
- 2** .5 SPHERE MOUNT VARIABLE
.5 SMV
- .5 SPHERE MOUNT VARIABLE NEGATIVE
.5 SMVN
- 3** .5 SHANKLESS SPHERE MOUNT
.5 SSM
- .5 SHANKLESS SPHERE MOUNT NEGATIVE
.5 SSMN
- 4** .5 SPHERE MOUNT THREADED
.5 SMT
- TBR RETAINER "BIRDCAGE"
- 5** .5 SPHERE MOUNT / LASER RADAR
.5 SM / LR
- .5 SPHERE MOUNT / TARGET CORNER
.5 SM / TC
- 6** .5 EDGE SPHERE MOUNT - OUTSIDE CORNER
.5 ESM - OC
- 7** DOUBLE VECTOR TARGET / SPHERE MOUNT LASER RADAR
DVT / SMLR
- 8** .5 SPHERE MOUNT / HIDDEN POINT BAR ADAPTOR
.5 SM / HPBA
- 9** .5 LASER TRACKER - REFERENCE SPHERE MOUNT
.5 LT - RSM
- 10** .5 FOUNDATION SPHERE MOUNT
.5 FSM
- .5 DRIFT NEST
.5 DN
- 11** .5 TRIPOD SPHERE MOUNT
.5 TSM
- 12** .5 FARO TRIPOD SPHERE MOUNT
.5 FARO TSM
- 13** HEAVY DUTY MAG HOLDER
LIGHT DUTY MAG HOLDER
- 14** .5 SMR MAGNETIC CLAMP
.5 SMR MC
- .5 SMR SUPPORT
- 15** 1.5 - .5 SMR ADAPTOR
1.5 - .5 SMR AD
- .875 - .5 SMR ADAPTOR
.875 - .5 SMR AD

.5 SM
 Designed to hold a .5000 Spherically Mounted Retro-Reflector on centerline of a hole and critical offset.

.5 SM ORDERING INFORMATION

	FAMILY	"H" TO CENTERLINE OF SPHERE	"A" SHANK DIAMETER	MATERIAL (OPTIONS)			
.5 SM STANDARD BUILD	.5 SM	↓	↓	1144 steel or (SS)			
CUSTOMER PROVIDES INFO	.5 SM	■	■	■			

.5 SMN
 Allows SMR rotation below horizontal.

.5 SMN ORDERING INFORMATION

	FAMILY	"H" TO CENTERLINE OF SPHERE	"A" SHANK DIAMETER	MATERIAL (OPTIONS)			
.5 SMN STANDARD BUILD	.5 SMN	↓	↓	1144 steel or (SS)			
CUSTOMER PROVIDES INFO	.5 SMN	■	■	■			

REFERENCE NOTES

.5 SPHERE MOUNT

CAD on file

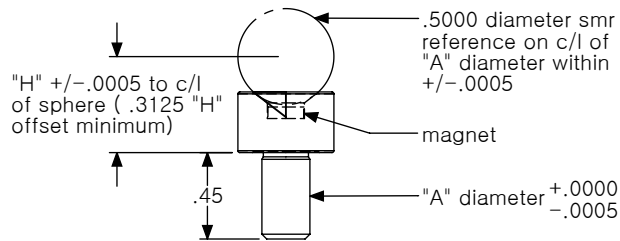

NOTE

For a .3125 offset only, the minimum shank possible with a magnetic insert is a .2500 shank. For shank sizes smaller than .2500 with a .3125 offset, use SMLR design or they will be non-magnetic.



.5 SM FEATURES
 1144 STEEL, BLACK OXIDE FINISH (standard)

STAINLESS STEEL OPTION (for more corrosive environments)

.5 SPHERE MOUNT NEGATIVE

CAD on file

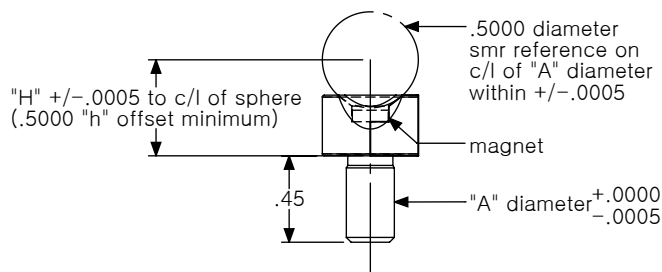

.5 SMN FEATURES
 1144 STEEL, BLACK OXIDE FINISH (standard)

STAINLESS STEEL OPTION (for more corrosive environments)

.5 SMV

Designed to hold a .5000 Spherically Mounted Retro-Reflector on centerline of a hole and critical offset. Variable design for your specific needs.

.5 SMVN

Allows SMR rotation below horizontal. Variable design for your specific needs.

.5 SMV ORDERING INFORMATION

	FAMILY	"H" TO CENTERLINE OF SPHERE	"A" SHANK DIAMETER	"B" SHANK LENGTH	MATERIAL (OPTIONS)		
.5 SMV STANDARD BUILD	.5 SMV	↓	↓	↓	1144 steel or (SS)		
CUSTOMER PROVIDES INFO	.5 SMV	▪	▪	▪	▪		

.5 SMVN ORDERING INFORMATION

	FAMILY	"H" TO CENTERLINE OF SPHERE	"A" SHANK DIAMETER	"B" SHANK LENGTH	MATERIAL (OPTIONS)		
.5 SMVN STANDARD BUILD	.5 SMVN	↓	↓	↓	1144 steel or (SS)		
CUSTOMER PROVIDES INFO	.5 SMVN	▪	▪	▪	▪		

REFERENCE NOTES

.5 SPHERE MOUNT VARIABLE

CAD on file

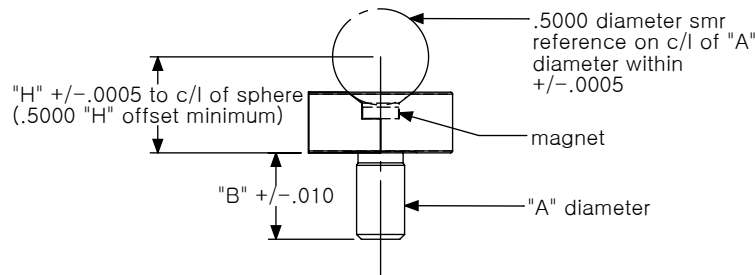

.5 SMV FEATURES
1144 STEEL, BLACK OXIDE FINISH (standard)

STAINLESS STEEL OPTION (for more corrosive environments)

.5 SPHERE MOUNT VARIABLE, NEGATIVE

CAD on file

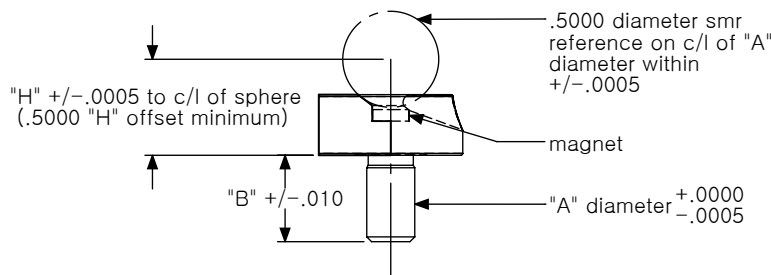

.5 SMVN FEATURES
1144 STEEL, BLACK OXIDE FINISH (standard)

STAINLESS STEEL OPTION (for more corrosive environments)

.5 SSM
 Supports .5000 Spherically Mounted Retro-Reflector for critical offset and centerline. The edge may be used to contact in edges to a value of .250 away.

.5 SSM ORDERING INFORMATION

	FAMILY	"H" TO CENTERLINE OF SPHERE	MATERIAL (OPTIONS)				
.5 SSM STANDARD BUILD	.5 SSM	↓	1144 steel or (SS)				
CUSTOMER PROVIDES INFO	.5 SSM	■					

.5 SSMN
 Allows SMR rotation below horizontal.

.5 SSMN ORDERING INFORMATION

	FAMILY	"H" TO CENTERLINE OF SPHERE	MATERIAL (OPTIONS)				
.5 SSMN STANDARD BUILD	.5 SSMN	↓	1144 steel or (SS)				
CUSTOMER PROVIDES INFO	.5 SSMN	■					

REFERENCE NOTES

.5 SHANKLESS SPHERE MOUNT

CAD on file

NOTE
 Minimum offset 10mm

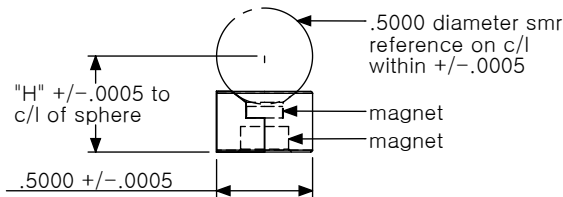

.5 SSM FEATURES
 1144 STEEL, BLACK OXIDE FINISH (standard)

STAINLESS STEEL OPTION
 (for more corrosive environments)

.5 SHANKLESS SPHERE MOUNT NEGATIVE

CAD on file

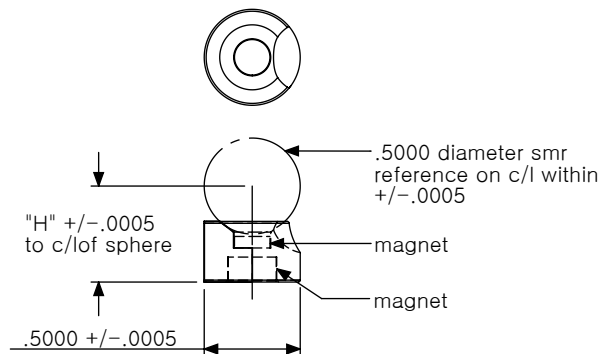

.5 SSMN FEATURES
 1144 STEEL, BLACK OXIDE FINISH (standard)

STAINLESS STEEL OPTION
 (for more corrosive environments)

.5 SMT

Designed to hold a .5 Spherically Mounted Retro-Reflector on centerline of a threaded hole and critical offset.

.5 SMT ORDERING INFORMATION

	FAMILY	"H" TO CENTERLINE OF SPHERE	"T" THREAD SIZE	MATERIAL (OPTIONS)			
.5 SMT STANDARD BUILD	.5 SMT	↓	↓	1144 steel or (SS)			
CUSTOMER PROVIDES INFO	.5 SMT	▪	▪	▪			

.5 TBR RETAINER "BIRDCAGE"

Snaps on .5 SM for added protection of keeping the sphere from falling out.

.5 TBR RETAINER "BIRDCAGE" ORDERING INFORMATION

	FAMILY	MODEL	FITS FOLLOWING OFFSETS
.5 TBR STANDARD BUILD	.5 TBR	1	.3125 and 10mm
	.5 TBR	2	12mm / .500 offset and high and 10mm
CUSTOMER PROVIDES INFO	.5 TBR	▪	

REFERENCE NOTES

.5 SPHERE MOUNT THREADED

CAD on file

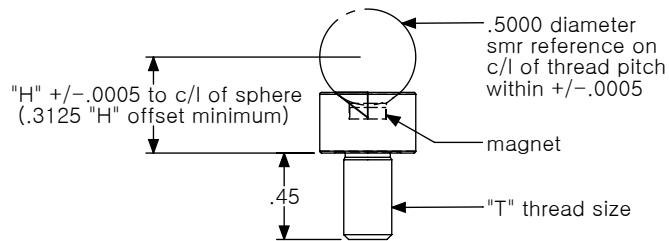

NOTE

M8 or 5/16 thread are the smallest size with .3125 offset that can be magnetic.



.5 SMT FEATURES

1144 STEEL, BLACK OXIDE FINISH (standard)

STAINLESS STEEL OPTION (for more corrosive environments)

.5 TBR RETAINER "BIRDCAGE"

.5 TBR RETAINER FEATURES

- Allows free rotation of the TBR from horizontal to vertical.
- Strong, rigid, durable plastic protects the surface of the TBR.
- Assembles and disassembles easily.



.5 SM / LR

Designed to hold a .5000 Spherically Mounted Retro-Reflector on centerline of a hole and critical offset when a non-magnetic mount is preferred.

.5 SM / LR ORDERING INFORMATION

	FAMILY	"H" TO CENTERLINE OF SPHERE	"A" SHANK DIAMETER	MATERIAL			
.5 SM / LR STANDARD BUILD	.5 SM / LR	↓	↓	1144 steel, black oxide finish			
CUSTOMER PROVIDES INFO	.5 SM / LR						

.5 SM / TC

Designed to hold a .5000 Spherically Mounted Retro-Reflector to target edges/surfaces.

.5 SM / TC ORDERING INFORMATION

	FAMILY	"H" TO CENTERLINE OF SPHERE	MATERIAL (OPTIONS)				
.5 SM / TC STANDARD BUILD	.5 SM / TC	5000	1144 steel or (SS)				
CUSTOMER PROVIDES INFO	.5 SM / TC						

REFERENCE NOTES

.5 SPHERE MOUNT / LASER RADAR

CAD on file

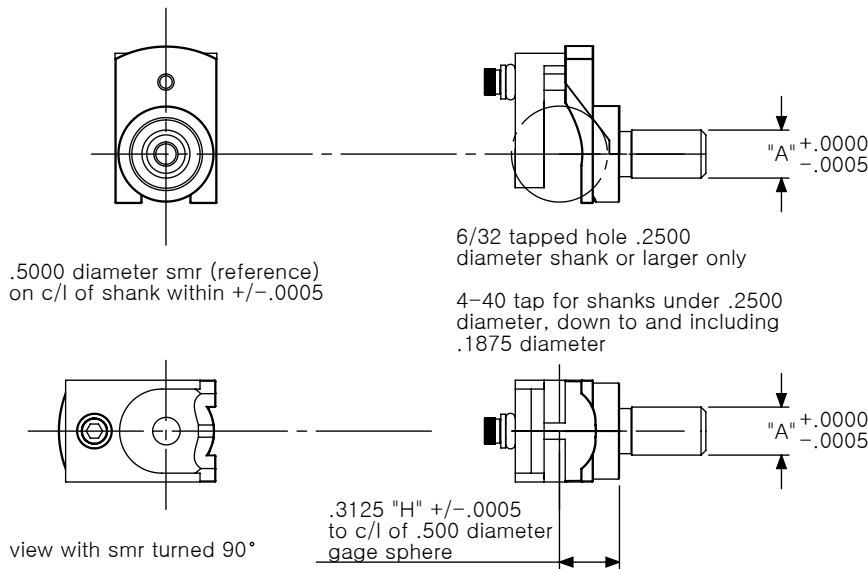

.5 SM / LR FEATURES

1144 STEEL, BLACK OXIDE FINISH (standard)

.5 SPHERE MOUNT / TARGET CORNER

CAD on file

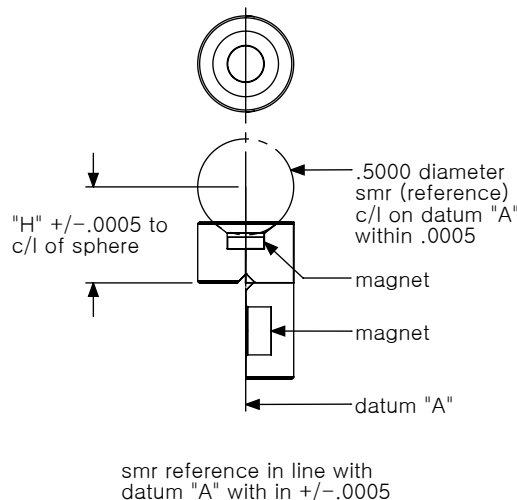

NOTE

10mm shortest offset on .5 SM / TC



.5 SM / TC FEATURES

1144 STEEL, BLACK OXIDE FINISH (standard)

STAINLESS STEEL OPTION (for more corrosive environments)

DVT / SMLR

Holds (2) Tooling Ball
Retro-Reflectors to
measure location and
angularity of a hole.

DVT / SMLR ORDERING INFORMATION

	FAMILY	"A" SHANK DIAMETER	MATERIAL (OPTIONS)				
DVT / SMLR STANDARD BUILD	DVT / SMLR	↓	1144 steel or (SS)				
CUSTOMER PROVIDES INFO	DVT / SMLR	▪	▪				
REFERENCE NOTES	_____						

DOUBLE VECTOR TARGET / SPHERE MOUNT LASER RADAR

CAD on file



DVT / SMLR FEATURES

1144 STEEL, BLACK OXIDE
FINISH (standard)

STAINLESS STEEL OPTION
(for more corrosive
environments)

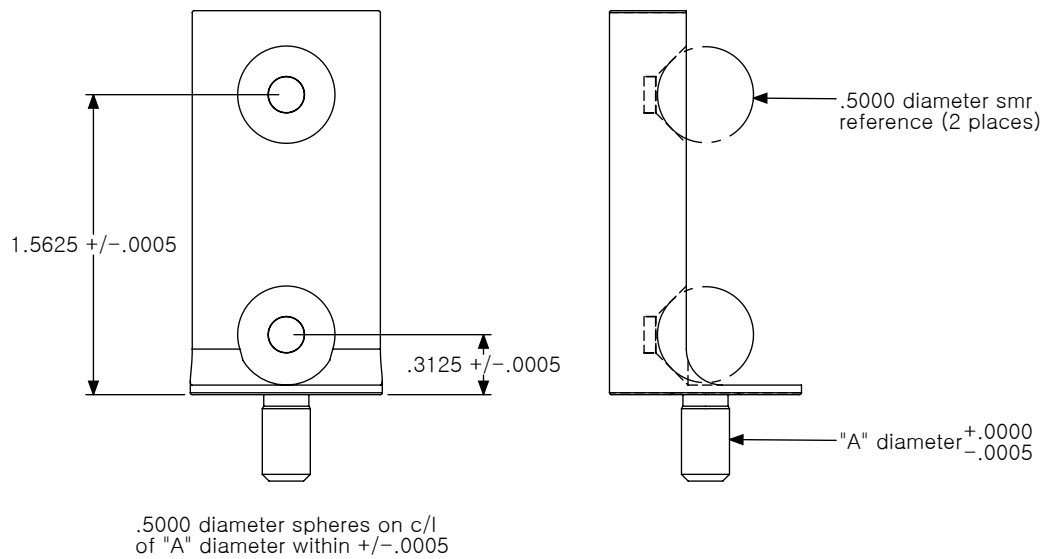

.5 SM / HPBA
 Assembles with various
 Bar Extension lengths
 and holds the .5 SMR on
 centerline for Hidden
 Point applications.

.5 SM / HPBA ORDERING INFORMATION

FAMILY		MATERIAL				
.5 SM / HPBA STANDARD BUILD	.5 SM / HPBA	1144 steel, black oxide finish				
	CUSTOMER PROVIDES INFO .5 SM / HPBA					
REFERENCE NOTES						

.5 SPHERE MOUNT HIDDEN POINT BAR ADAPTOR

CAD on file



**.5 SM / HPBA
 FEATURES**
 1144 STEEL, BLACK OXIDE
 FINISH (standard)

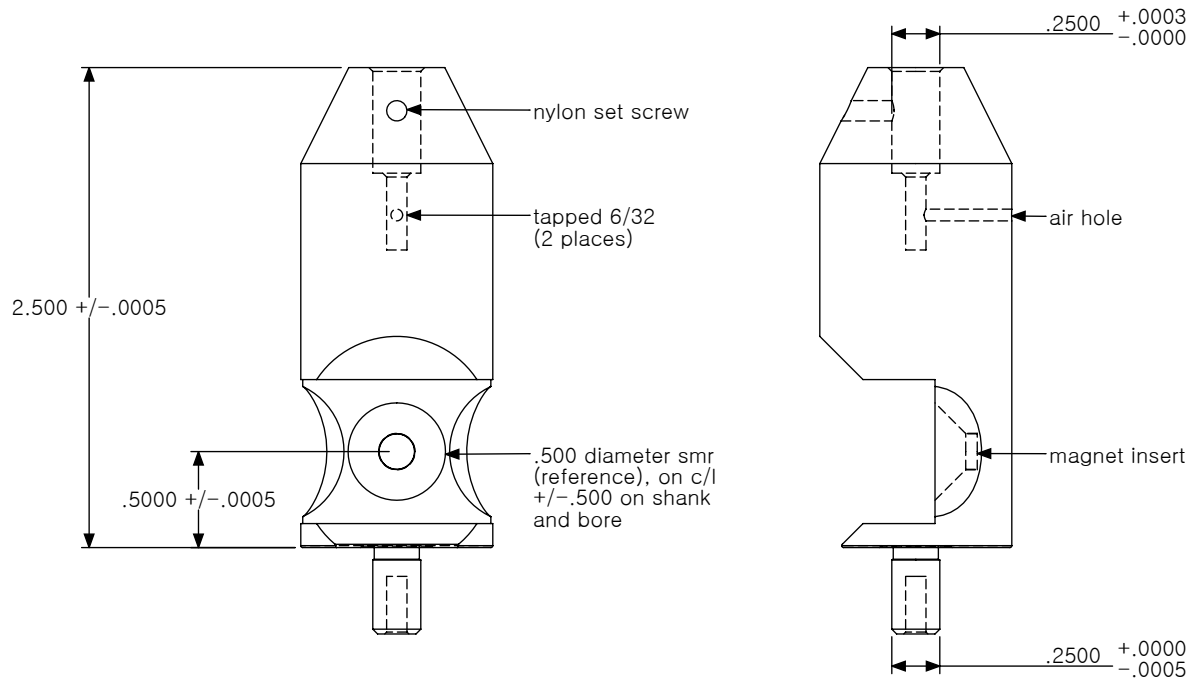

.5 LT - RSM

Designed to hold .5000 Spherically Mounted Retro-Reflector as a permanent reference point.

.5 LT - RSM ORDERING INFORMATION

	FAMILY	"H" TO CENTERLINE OF SPHERE	MATERIAL				
LT-RSM STANDARD BUILD	LT-RSM	16mm	1144 steel, black oxide finish				
CUSTOMER PROVIDES INFO	LT-RSM						
REFERENCE NOTES							

.5 LASER TRACKER - REFERENCE SPHERE MOUNT

CAD on file



.5 LT - RSM
FEATURES
 1144 STEEL OXIDE FINISH
 (standard)

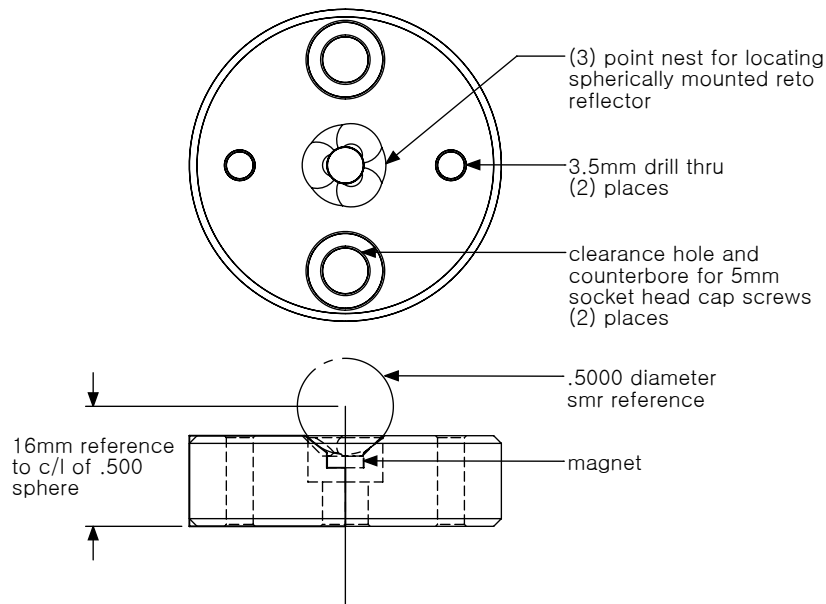

.5 ESM / OC
 Designed to hold
 Spherically Mounted
 Retro-Reflector for the
 purpose of locating
 outside corners.

.5 ESM / OC ORDERING INFORMATION

	FAMILY	MATERIAL (OPTIONS)					
.5 ESM / OC STANDARD BUILD	.5 ESM / OC	1144 steel or (SS)					
CUSTOMER PROVIDES INFO	.5 ESM / OC ■						
REFERENCE NOTES	_____						

.5 EDGE SPHERE MOUNT / OUTSIDE CORNER

CAD on file

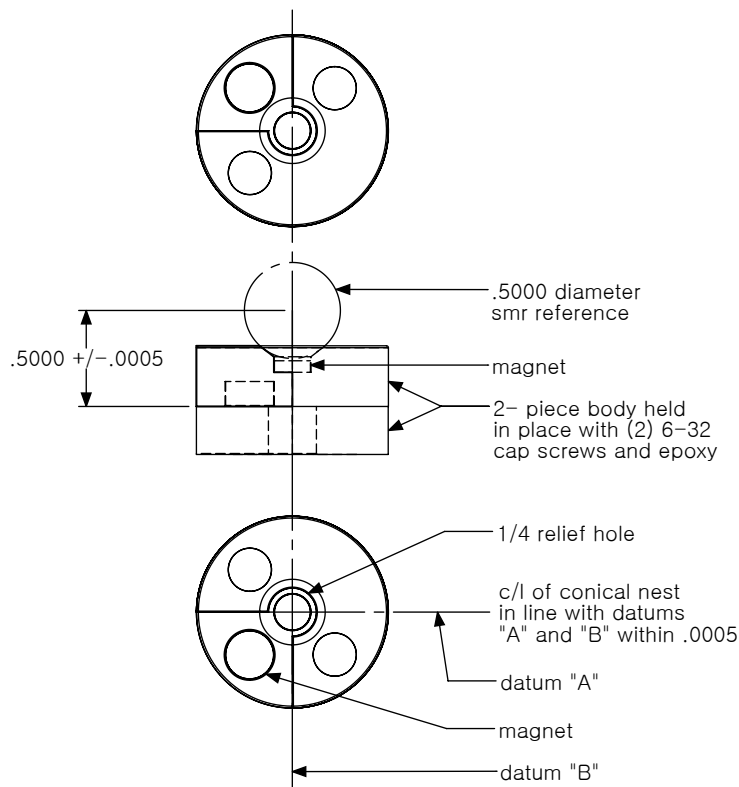

**.5 ESM / OC
 FEATURES**
 1144 STEEL, BLACK OXIDE
 FINISH (standard)

STAINLESS STEEL OPTION
 (for more corrosive
 environments)

.5 FSM
 Mounted in concrete flooring/foundations, etc. to allow for a permanent Laser Tracker target reference.

.5 FSM ORDERING INFORMATION

	FAMILY	MATERIAL					
.5 FSM STANDARD BUILD	.5 FSM	stainless steel (SS)					
CUSTOMER PROVIDES INFO	.5 FSM						

.5 DN
 Designed to hold .5000 Spherically Mounted Retro-Reflector as a temporary reference point.

.5 DN ORDERING INFORMATION

	FAMILY	MATERIAL					
.5 DN STANDARD BUILD	.5 DN	1144 steel, black oxide finish					
CUSTOMER PROVIDES INFO	.5 DN						

REFERENCE NOTES

.5 FOUNDATION SPHERE MOUNT

CAD on file

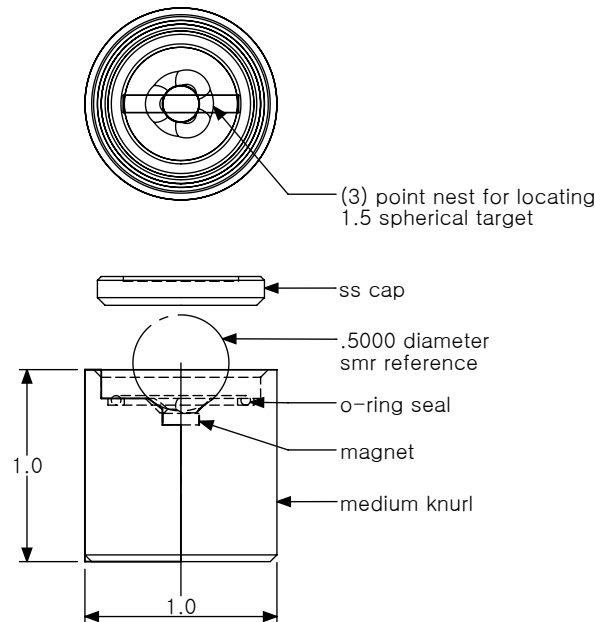

.5 FSM FEATURES
 STAINLESS STEEL (standard)

.5 DRIFT NEST

CAD on file

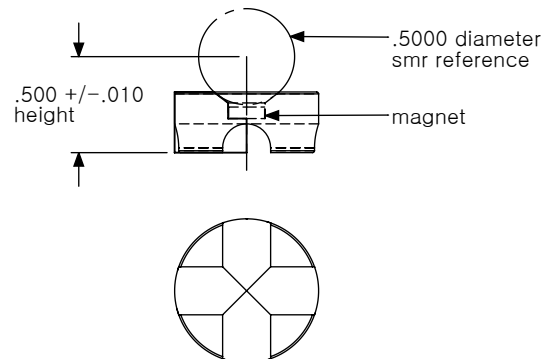

NOTE

To Use: Hold .5 Reflector Holder Drift Nest in place and inject hot glue into (1) of the (4) tunnels until hot glue protrudes out of the other sides.



.5 DN FEATURES
 1144 STEEL, BLACK OXIDE FINISH (standard)

.5 TSM ORDERING INFORMATION

.5 TSM
 Mounted to a
 Theodolite adaptor to
 hold a .5 Spherically
 Mounted Retro-Reflector
 in place for a constant
 reference point.

	FAMILY	MATERIAL (OPTIONS)					
.5 TSM STANDARD BUILD	.5 TSM	1144 steel, black oxide finish					
CUSTOMER PROVIDES INFO	.5 TSM						
REFERENCE NOTES							

.5 TRIPOD SPHERE MOUNT

CAD on file



.5 TSM FEATURES
 1144 STEEL, BLACK OXIDE FINISH (standard)

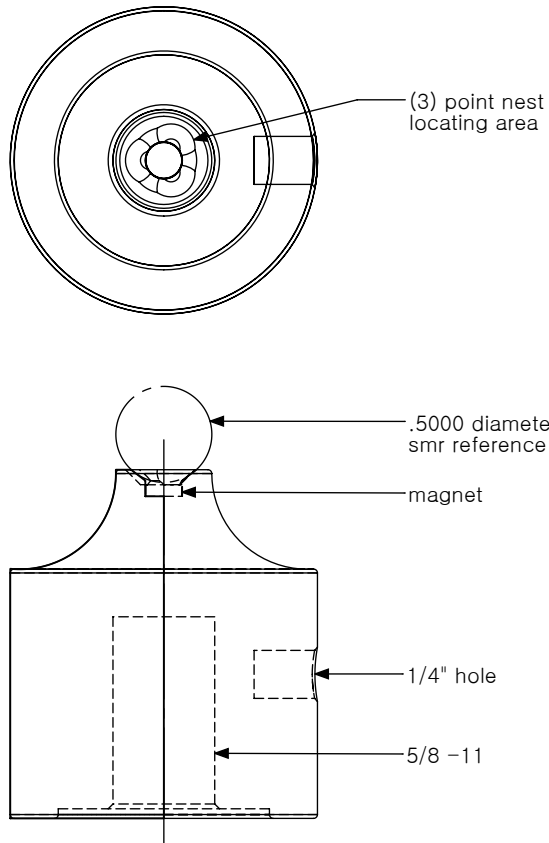

.5 TSM (FARO)

Mounted to a Theodolite adaptor to hold a .5 Spherically Mounted Retro-Reflector in place for a constant reference point.

.5 TSM (FARO) ORDERING INFORMATION

	FAMILY	MATERIAL (OPTIONS)					
.5 TSM (FARO) STANDARD BUILD	.5 TSM (FARO)	1144 steel, black oxide finish					
CUSTOMER PROVIDES INFO	.5 TSM (FARO)						
REFERENCE NOTES							

.5 TRIPOD SPHERE MOUNT (FARO)

CAD on file



.5 TSM (FARO) FEATURES
1144 STEEL, BLACK OXIDE FINISH (standard)

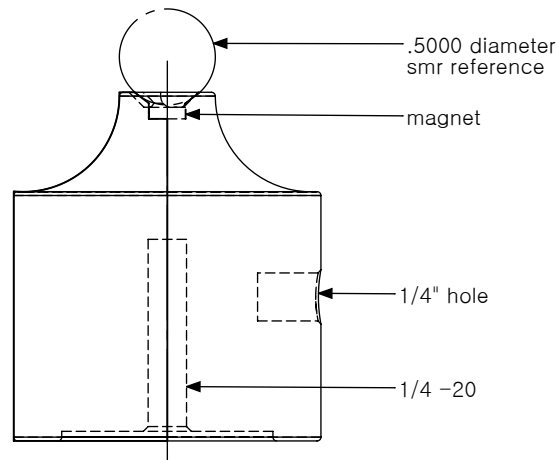

MAGNETIC HOLDER

Designed to hold .5000 Spherically Mounted Retro-Reflector during use.

MAGNETIC HOLDER ORDERING INFORMATION

	FAMILY	MODEL	BEST FOR
.5 TBR STANDARD BUILD	MAGNETIC HOLDER	HEAVY DUTY	Holding .5 SMR when profiling surfaces
	MAGNETIC HOLDER	LIGHT DUTY	Placing or removing .5 SMR from nest
CUSTOMER PROVIDES INFO	.5 TBR	■	
REFERENCE NOTES			

HEAVY DUTY MAGNETIC HOLDER FOR TBR



FEATURES

- Allows free rotation of the TBR from horizontal to vertical.
- Assembles and disassembles easily.

LIGHT DUTY MAGNETIC HOLDER FOR TBR



FEATURES

- Allows free rotation of the TBR from horizontal to vertical.
- Assembles and disassembles easily.

.5 SMR MC and .5 SMR SUPPORT

Designed to hold a
sphere directly on
the surface.

.5 SMR MC ORDERING INFORMATION

	FAMILY	MATERIAL					
.5 SMR MC STANDARD BUILD	.5 SMR MC	1144 steel, black oxide finish					
CUSTOMER PROVIDES INFO	.5 SMR MC						

.5 SMR SUPPORT ORDERING INFORMATION

	FAMILY	MATERIAL					
.5 SMR SUPPORT STANDARD BUILD	.5 SMR SUPPORT	1144 steel, black oxide finish					
CUSTOMER PROVIDES INFO	.5 SMR SUPPORT						

REFERENCE
NOTES

.5 SMR MAGNETIC CLAMP

CAD on file

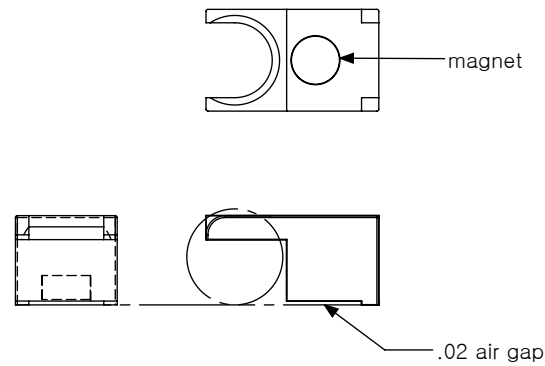

**.5 SMR MC
FEATURES**
1144 STEEL, BLACK OXIDE
FINISH (standard)

.5 SMR SUPPORT

CAD on file

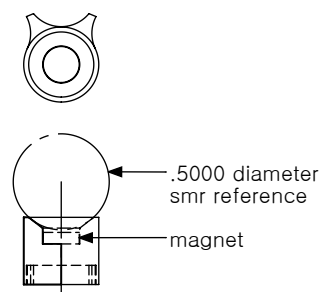

**.5 SMR
SUPPORT
FEATURES**
1144 STEEL, BLACK OXIDE
FINISH (standard)

1.5 - .5 SMR AD
 Designed to adapt a
 1.5 Sphere Mount Nest
 to .5000 Spherically
 Mounted Retro-Reflector.

1.5 - .5 SMR AD ORDERING INFORMATION

	FAMILY	MATERIAL					
1.5 - .5 SMR AD STANDARD BUILD	1.5 - .5 SMR AD	stainless steel (SS)					
CUSTOMER PROVIDES INFO	1.5 - .5 SMR AD						

.875 - .5 SMR AD
 Designed to adapt
 a .8750 Sphere Mount
 Nest to .5 Spherically
 Mounted Retro-Reflector.

.875 - .5 SMR AD ORDERING INFORMATION

	FAMILY	MATERIAL					
.875 - .5 SMR AD STANDARD BUILD	.875 - .5 SMR AD	stainless steel (SS)					
CUSTOMER PROVIDES INFO	.875 - .5 SMR AD						

REFERENCE
NOTES

1.5 - .5 SMR AD

CAD on file

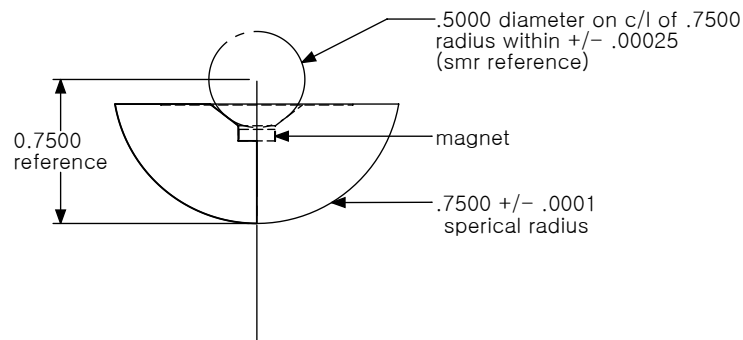

**1.5 - .5 SMR AD
 FEATURES**
 STAINLESS STEEL
 Heat-treated and
 hardened to R/C 53 - 55
 (standard)

.875 - .5 SMR AD

1
15

CAD on file

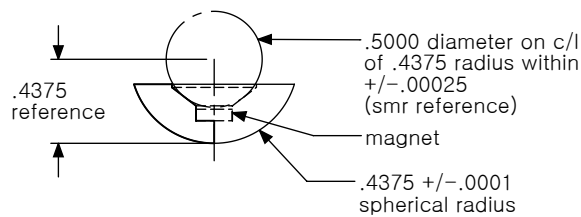

**.875 - .5 SMR AD
 FEATURES**
 STAINLESS STEEL
 Heat-treated and
 hardened to R/C 53 - 55
 (standard)